

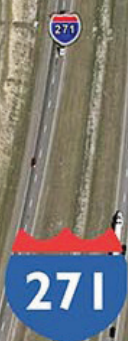

CUSHMAN &  
WAKEFIELD

CRESCO  
Real Estate



Mount Pleasant  
Church of God

Mother  
Teresa  
Manor

Bedford Heights  
City Services &  
Recreation

Perkins Road

**COLUMBUS & PERKINS ROAD**  
Bedford Heights, Ohio 44146



# I-271/ROCKSIDE ROAD

Columbus & Perkins Road, Bedford Heights, Ohio 44146

## LOT SIZE

6.9 acres

## SALE PRICE

\$850,000

## PROPERTY HIGHLIGHTS

- Excellent location, visible from I-271
- The Southeast Corridor, which encompasses Bedford Heights, is home to nearly 1.5 million residents
- Located near shopping and service amenities
- Pro-development community in a well established city

## DENSITY

184 potential units

## TOPOGRAPHY

Flat and cleared

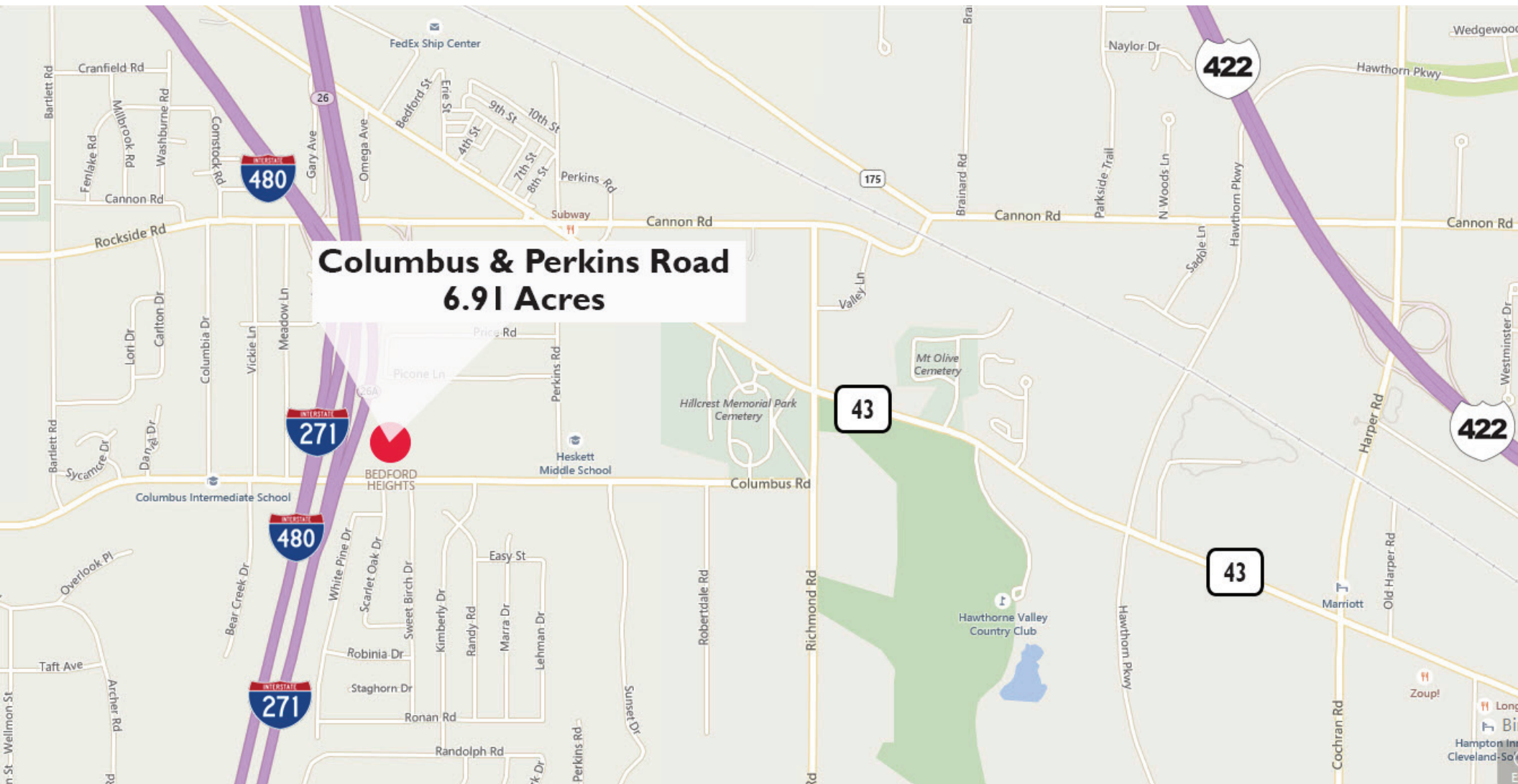

# I-271/ROCKSIDE ROAD

Columbus & Perkins Road, Bedford Heights, Ohio 44146

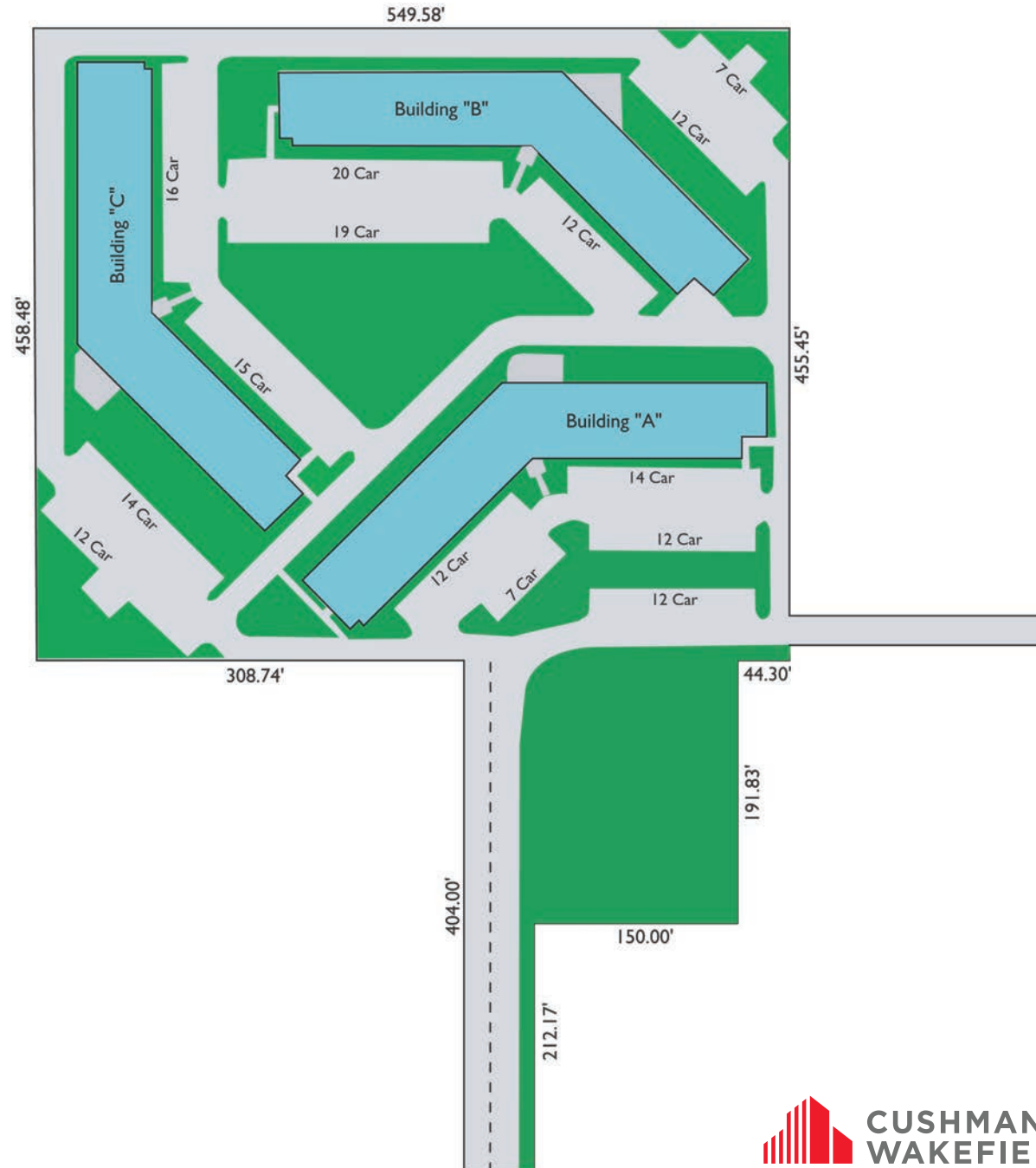

# I-271/ROCKSIDE ROAD

Columbus & Perkins Road, Bedford Heights, Ohio 44146

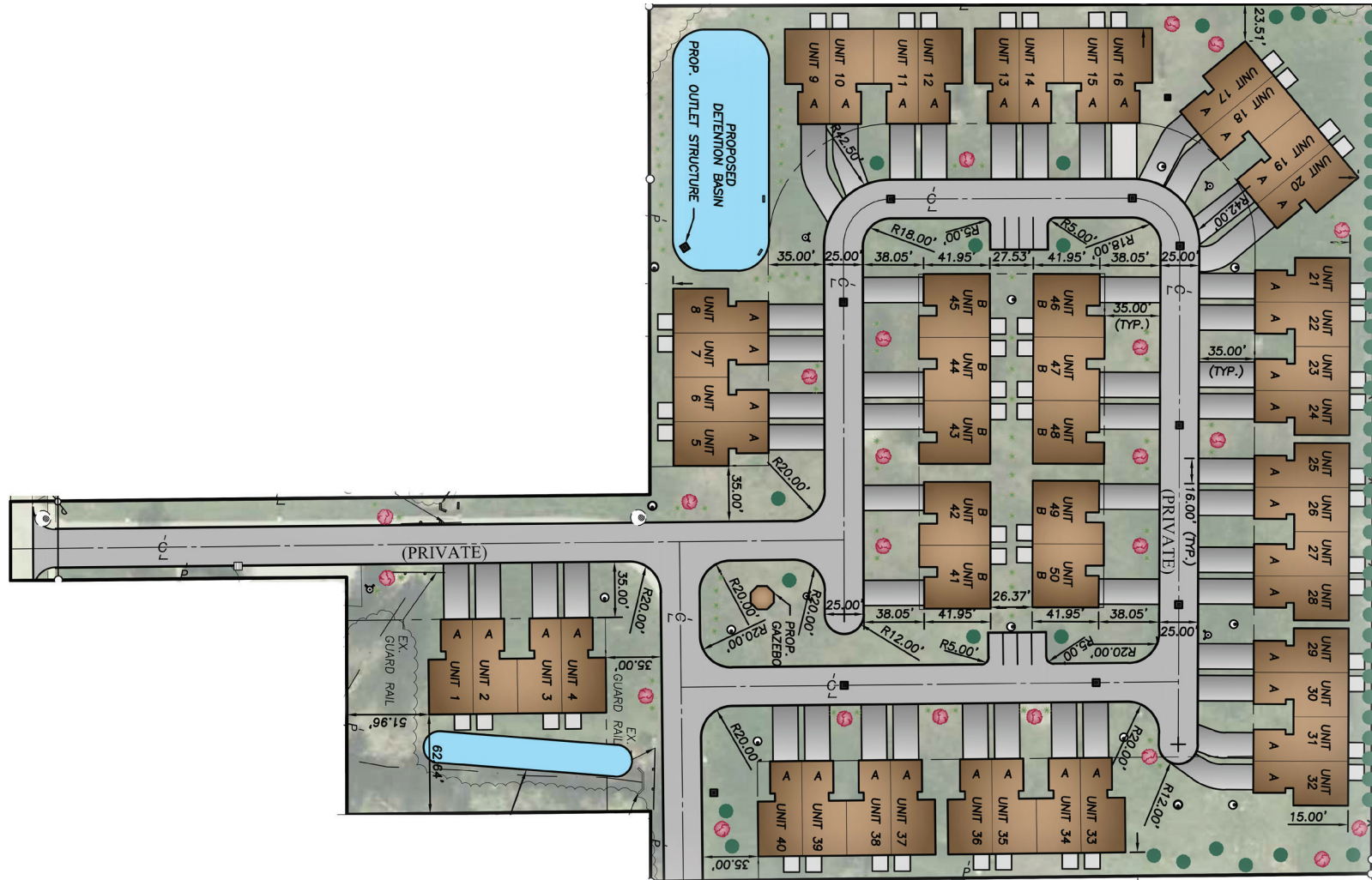

**BOB GARBER, SIOR** / Executive Vice President & Partner Emeritus  
bgarber@crescorealestate.com / +1 216 525 1467

3 Summit Park Drive, Suite 200  
Cleveland, Ohio 44131  
Main +1 216 520 1200  
Fax +1 216 520 1828  
[crescorealestate.com](http://crescorealestate.com)

Independently Owned and Operated / A Member of the Cushman & Wakefield Alliance

Cushman & Wakefield Copyright 2022. No warranty or representation, express or implied, is made to the accuracy or completeness of the information contained herein, and same is submitted subject to errors, omissions, change of price, rental or other conditions, withdrawal without notice, and to any special listing conditions imposed by the property owner(s). As applicable, we make no representation as to the condition of the property (or properties) in question. A licensee at Cushman & Wakefield | CRESCO may have an interest in the client entity offering this property for sale.

